



ISO9001  CE RoHS

WR34615

2.9V Lithium Sulfur Dioxide Cells

Benefits

- High discharge current at low temperature application.
Energy density,(330Wh/Kg).
- Stable voltage with open circuit voltage greater than 2.9V and operating voltage 2.5V to 2.8V.
- Wide range of operating temperature (-50 °C~+75 °C).
- Long shelf life(over 10 years at normal room temperature).

Main application

- Intelligent Instrument and meter
- Memory and standby power
- Alarms and security devices
- Automotive electronics
- Electronic toll collection
- Military devices

Electrical characteristics (23±2°C)

Nominal capacity	7.8Ah
Nominal voltage	2.9V
Maximum recommended continuous current	4000mA
Maximum recommended pulse current	6000mA
Operating temperature range	-55 °C~+65 °C

 U.L. Component Recognition MH 29130

Physical characteristics

Diameter[max]	34.0mm
Height[max]	61.5mm
Typical weight	90g

Available terminations

S: Standard terminations

T: Solder tabs

P: Axial pins

Special termination are available upon request.

MSDS is available upon request.

Wuhan Voltec Energy Sources Co.,Ltd.

Add: Wuhan zhongyuanChangjiang Scientific Tecnology park,
Nansan Road, Hannan Economy Dev.zone, Wuhan

Tel: +86-27-84732152 84732116

Fax: +86-84662179

Website:www.voltec-sunmoon.com

E-mail:sunmoon@voltec-sunmoon.com



ISO9001 CE RoHS

WR34615

2.9V Lithium Sulfur Dioxide Cells

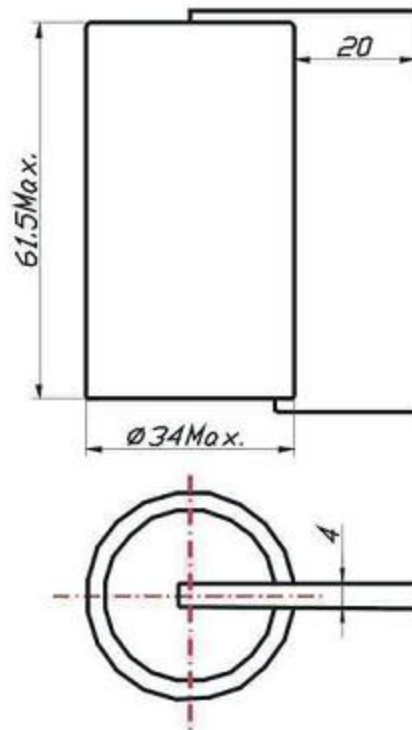

S: Standard termination

Warning:

- Fire, explosion and burn hazard.
- Do not recharge, short circuit, crush, disassemble, heat above 100°C incinerate.
- Do not use the battery beyond permitted temperature range.

Discharge Characteristics at (20±2°C)

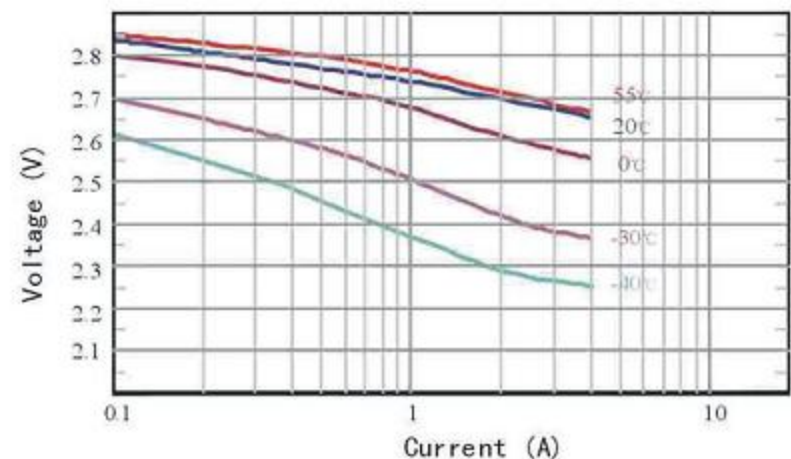
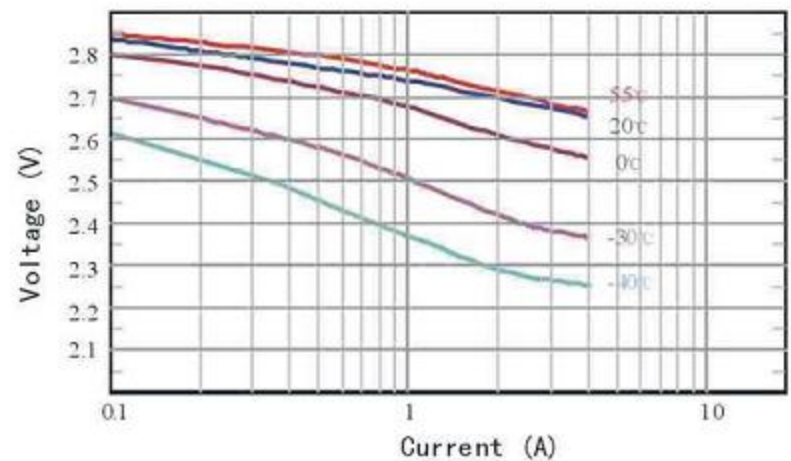
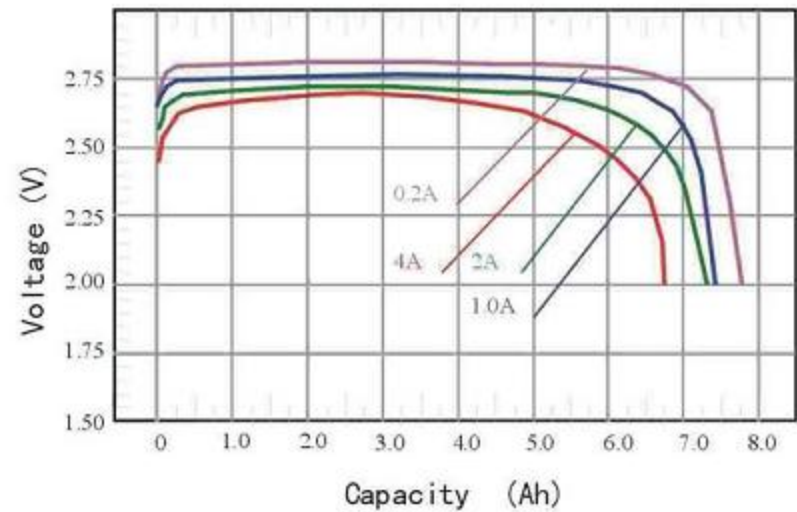

Wuhan Voltec Energy Sources Co.,Ltd.

Add: Wuhan zhongyuanChangjiang Scientific Tecnology park,
Nansan Road, Hannan Economy Dev.zone, Wuhan

Tel: +86-27-84732152 84732116

Fax: +86-84662179

Website: www.voltec-sunmoon.com

E-mail: sunmoon@voltec-sunmoon.com